

# Weld-On Pivot Link



**SEE APPLICATION AND WARNING INFORMATION**  
 Para Español: [www.thecrosbygroup.com](http://www.thecrosbygroup.com) On Pages 180-181

## S-265



- Forged Steel — Quenched and Tempered.
- Forged from 1035 Carbon Steel.
- Excellent welding qualities.
- Widely used on farm machinery, trucks, steel hulled marine vessels and material handling equipment.
- Appropriate welding instructions are available upon request.

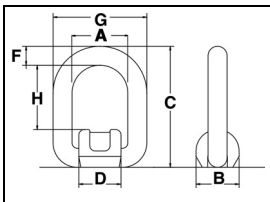

## S-265 Weld-On Pivot Link

Working Load Limit (t)		S-265 Stock No.	Weight Each (kg)	Dimensions (mm)							Minimum Fillet Weld Size (mm)
Design Factor 5:1	Design Factor 4:1			A	B	C	D	F	G	H	
1	1.2	1290740	.40	40	36	83	35	13	66	42	3
2.5	3.2	1290768	.60	45	44	99	42	18	81	48	3
4	5.3	1290786	1.20	55	50	123	49	22	99	57	6
6.4	8	1290802	2.40	70	64	144	64	26	122	67	6
12	15	1290820	5.90	97	90	193	86	34	165	94	8

Rigging Accessories